



PLOMBCO WHEEL WEIGHTS

— 2015 CATALOG —

PLOMBCO.COM

2.0 VERSION

INCLUDING



plasteel
PREMIUM WHEEL WEIGHTS



ABOUT PLOMBCO

Plombco is a privately held company located in Valleyfield, Québec, Canada. Founded in 1985, Plombco has grown to become one of the largest manufacturers of wheel balancing weights in the world. With quality-minded employees we produce over one million units per day in our two highly automated facilities. Our products are sold to OEM's and aftermarket customers across the Americas, Europe and Asia. We offer the most innovative and comprehensive product lines in the industry to meet virtually any balancing need.

INNOVATION

Plombco believes that you must be an innovator to continue to thrive in a competitive marketplace. We have worked tirelessly to try to solve the everyday problems faced by our industry. Our engineering team is always striving for better ways to get the job done. Whether it is through new products, automation, or packaging; you can count on the team at Plombco to provide you with the best products to use in the balancing process.



OUR TEAM

Plombco and its dedicated employees are determined to go beyond good service and exceed our customers' expectations. We have developed a team of competent and dynamic leaders capable of driving all aspects of the operation from development, to production and service. It is our core belief that we need to keep raising the bar to lead the industry.

TABLE OF CONTENTS

Clip-on Wheel Weights	4-9
Plasteel®	4
Steel	7
Lead.....	8
Zinc.....	9
Truck Wheel Weights	11
Adhesive Wheel Weights.....	13-17
Steel	14
Lead.....	16
Zinc.....	17
Assortment Kits	19
Tools & Accessories	20
Specialty Wheel Weights	23

CLIP-ON WHEEL WEIGHTS

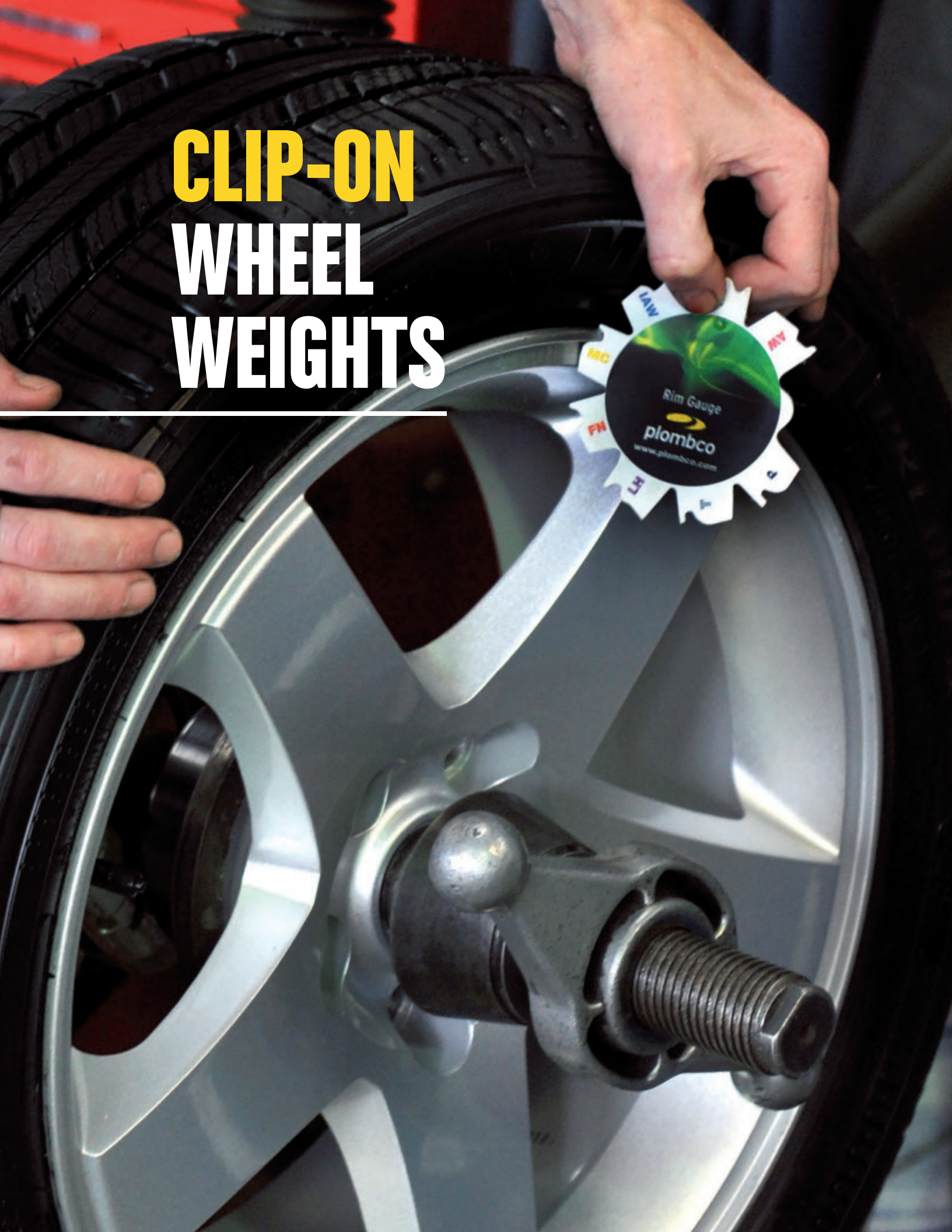

plasteel®

PREMIUM WHEEL WEIGHTS



VISIT PLASTEELWHEELWEIGHTS.COM
TO VIEW THE VIDEOS

A WORLD PREMIERE

The market is shifting towards lead-free alternatives, and we have listened to the feedback from our customers in the field. Important issues, such as the increased popularity of clad wheels on new vehicles, demonstrated that there is a need for a better alternative than steel or zinc. **Plombco has developed a world first; a steel core wheel weight encased in a plastic shell. No other manufacturer offers this patented product.**

FEATURES

- + Less expensive than lead and zinc
- + Meets OEM standards
- + Scratchless & easy application
- + Exceptional corrosion resistance
- + As malleable as lead
- + Best recyclability
- + Precise fit & looks good
- + 1/4 oz with a real body: see below



SEE OUR PLASTEEL® SAMPLE KIT ON PAGE 20

Plasteel® has a dedicated toll free number: 1 888 558-7854

Visit www.plasteelwheelweights.com for more information on Plasteel® product line.



PREMIUM PRODUCT AT THE BEST PRICE

MCPS

1/4 oz to 3 oz



Used on most North American vehicles with alloy wheels

IAWPS

5 g to 60 g



Used on some European and some Asian vehicles with alloy wheels

FNPS

5 g to 60 g



Used on most Japanese vehicles with alloy wheels

ENPS

5 g to 60 g



Used on Mercedes, Audi and Volkswagen. Also used on many aftermarket alloy wheels with thin rim flanges

TPS

1/4 oz to 3 oz



Used on some light trucks and SUV's with alloy or steel wheels

AWPS

1/4 oz to 3 oz



Used on most domestic vehicles prior to 1995 with alloy wheels

PLASTEEL® IS AVAILABLE ONLY FOR ALLOY WHEELS. FOR STEEL WHEELS USE PF_e OR REGZ.

PLOMBCO IS THE ONLY WHEEL WEIGHTS MANUFACTURER TO OFFER 4 DIFFERENT PRODUCT LINES GIVING YOU ALL THE LATITUDE YOU NEED TO FULFILL YOUR SPECIFIC NEEDS.

In addition, Plasteel® is patented product that is available only from Plombco. To help our customers select the right wheel weight, color coding is used on our labels, kits, application charts and gauges.

FOUR DIFFERENT MATERIALS

The color code is used on the labels, kits, application chart and gauge. You may refer to application chart or rim gauge to confirm specific application.

STYLE	APPLICATION	PLASTEEL® (PS)	STEEL (Fe)	ZINC (Z)	LEAD
P/REG	STEEL WHEELS	-	PFe	REGZ/REGZS	REGS/REG
MC	MOST NORTH AMERICAN	MCPS	MCFe	MCZS	MCS/MC
IAW	SOME EUROPEAN AND ASIAN	IAWPS	IAWFe	IAWZS	IAWS
FN	MOST ASIAN	FNPS	FNFe	FNZS	FNS
EN	MERCEDES, VW & AUDI	ENPS	ENFe	ENZS	ENS
T	PICK-UPS WITH STEEL RIMS	TPS	TFe	TZS	TS
LH	OLDER CHRYSLER	-	LHFe	LHZS	LHS
AW	OLDER NORTH AMERICAN	AWPS	AWFe	AWZS	AWS/AW

PRACTICAL PACKAGING

Our unique one size case helps you save space in your warehouse. It is designed to ship two, four or eight boxes per case. The reclosable lid can be used for reshipping purposes.



2 BOXES PER CASE



4 BOXES PER CASE



8 BOXES PER CASE

STEEL WHEEL WEIGHTS VALUE LINE

PFe

1/4 oz to 3 oz
Coated only



Used on passenger vehicles, full size pickups and vans with steel wheels

Note: For applications on full size pickups and vans, we recommend the use of our TPS or TFe series for light trucks weights. Use of PFe weights may cause overstressing of the clip resulting in failures.

MCFe

1/4 oz to 3 oz
Coated only



Used on most North American vehicles with alloy wheels

IAWFe

5 g to 60 g
Coated only



Used on some European and some Asian vehicles with alloy wheels

FNFe

5 g to 60 g
Coated only



Used on most Japanese vehicles with alloy wheels

ENFe

5 g to 60 g
Coated only



Used on Mercedes, Audi and Volkswagen. Also used on many aftermarket alloy wheels with thin rim flanges

TFe

1/4 oz to 3 oz
Coated only



Used on some light trucks and SUV's with alloy or steel wheels

LHFe

1/4 oz to 3 oz
Coated only



Used on older Chrysler vehicles with alloy wheels

AWFe

1/4 oz to 3 oz
Coated only



Used on most domestic vehicles prior to 1995 with alloy wheels

LEAD WHEEL WEIGHTS

REG and REGS

1/4 oz to 6 oz
Coated and uncoated



Used on passenger vehicles with alloy or steel wheels. All sizes 1¹/₄ oz and larger feature a 1" wide "V" clip for superior retention strength.

Note: For applications on full size pickups and vans, we recommend the use of our TS series for light trucks weights. Use of REG weights may cause overstressing of the clip resulting in failures.

MCS

1/4 oz to 4 oz
Coated and uncoated



Used on most North American vehicles with alloy wheels

IAWS

5 g to 60 g
Coated only



Used on some European and some Asian vehicles with alloy wheels

FNS

5 g to 70 g
Coated only



Used on most Japanese vehicles with alloy wheels

ENS

5 g to 60 g
Coated only



Used on Mercedes, Audi and Volkswagen vehicles. Also used on many aftermarket alloy wheels with thin rim flanges

TS

1/4 oz to 5 oz
Coated only



Used on some light trucks and SUV's with alloy or steel wheels

LHS

1/4 oz to 3 oz
Coated only



Used on older Chrysler vehicles with alloy wheels

AWS

1/4 oz to 3 oz
Coated and uncoated



Used on most domestic vehicles prior to 1995 with alloy wheels

WARNING: Some states, municipalities and companies may restrict the use of lead. Plombco's exclusive Plasteel® offers the best alternative to lead wheel weights. Please refer to page 4 & 5.

ZINC WHEEL WEIGHTS

REGZ and REGZS

1/4 oz to 3 oz
Coated and uncoated



Used on passenger vehicles with alloy or steel wheels. All sizes 3/4 oz and larger feature a 1" wide "V" clip for superior retention strength.

Note: For applications on full size pickups and vans, we recommend the use of our TZS series for light trucks weights. Use of REGZ weights may cause overstressing of the clip resulting in failures.

MCZS

1/4 oz to 3 oz
Coated only



Used on most North American vehicles with alloy wheels

IAWZS

5 g to 60 g
Coated only



Used on some European and some Asian vehicles with alloy wheels

FNZS

5 g to 60 g
Coated only



Used on most Japanese vehicles with alloy wheels

ENZS

5 g to 60 g
Coated only



Used on Mercedes, Audi and Volkswagen. Also used on many aftermarket alloy wheels with thin rim flanges

TZS

1/4 oz to 3 oz
Coated only



Used on some light trucks and SUV's with steel or aluminum wheels

LHZS

1/4 oz to 3 oz
Coated only



Used on older Chrysler vehicles with alloy wheels

AWZS

1/4 oz to 3 oz
Coated only



Used on most domestic vehicles prior to 1995 with alloy wheels

TRUCK WHEEL WEIGHTS



TRUCK WHEEL WEIGHTS

30
Zn
65.38

ZINC

CTZ

2 oz to 6 oz
Uncoated only



Available in 2, 3, 4, 5 & 6 oz sizes.
Used on heavy trucks with steel
rims, straight rim flanges

I7Z

1 oz to 8 oz
Uncoated only



Available in 1, 2, 3, 4, 5, 6 & 8 oz
sizes. Used on heavy trucks with
steel wheels

LT1Z

1/2 oz to 5 oz
Uncoated only



Available in 0.50, 1, 1.50, 2, 2.50, 3,
3.50, 4, 4.50, 5 oz sizes. Used on
3/4 and 1-ton light trucks with
steel wheels

RCZ

2 oz to 6 oz
Uncoated only



Available in 2, 3, 4, 5 & 6 oz sizes.
Used on heavy trucks and all steel
wheels with curves flanges

TALZS

2 oz to 6 oz
Coated only



Available in 2, 3, 4, 5 & 6 oz sizes.
Used on heavy trucks with alloy
wheels. Single weight fits both
sides of the wheel

82
Pb
207.20

LEAD

CT

2 oz to 14 oz
Uncoated only



Available in 2, 3, 4, 6, 8, 10, 12 &
14 oz sizes. Used on heavy trucks
with steel wheels, straight rim
flanges

I7

2 oz to 14 oz
Uncoated only



Available in 2, 3, 4, 5, 6, 8, 10, 12 &
14 oz sizes. Used on heavy trucks
with steel wheels

LT1

1/2 oz to 6 oz
Uncoated only



Available in 0.50, 1, 1.50, 2, 2.50, 3,
3.50, 4, 4.50, 5 & 6 oz sizes. Used
on 3/4 and 1-ton light trucks with
steel wheels

LT2

1 oz to 6 oz
Uncoated only



Available in 1, 2, 3, 4, 5 & 6 oz
sizes. Used on 3/4 and 1-ton light
trucks with steel wheels too thick
for LT1 series

RC

2 oz to 12 oz
Uncoated only



Available in 2, 3, 4, 6, 8, 10 & 12 oz
sizes. Used on heavy trucks and all
steel wheels with curved flanges

TALS

2 oz to 8 oz
Coated only



Available in 2, 3, 4, 6 & 8 oz sizes.
Used on heavy trucks with alloy
wheels. Single weight fits both
sides of the wheel

ADHESIVE WHEEL WEIGHTS



ADHESIVE WHEEL WEIGHTS

PLOMBCO OFFERS 3 DIFFERENT ADHESIVES TO COVER ALL APPLICATIONS

STANDARD

- For general purpose
- Widely used in North America
- White foam carrier

COLD WEATHER (CW)

- Exceptional adherence in cold temperatures, as low as 15°F (-10°C)
- Grey foam carrier

OE APPROVED (OE)

- Norton® adhesive with easy peel liner
- Widely used by European car manufacturers
- Re-positionable and heat resistant
- Black foam carrier



X4BIO CLEANS AND IMPROVES ADHERENCE

X4bio will easily clean your wheel and improve wheel weights adherence. Its specifically formulated ingredients interact with our adhesive to increase retention by up to 25%. This product is indispensable if your aim is trouble free balancing.

Part number: 44010

INSTALLATION INSTRUCTION

For environmental reasons the car manufacturers recently started using water-based paint on wheels. Unfortunately, those paints have an adverse effect on the adherence of wheel weights. The special formulation of X4bio assures optimal adherence even on surfaces coated with water-based paint.

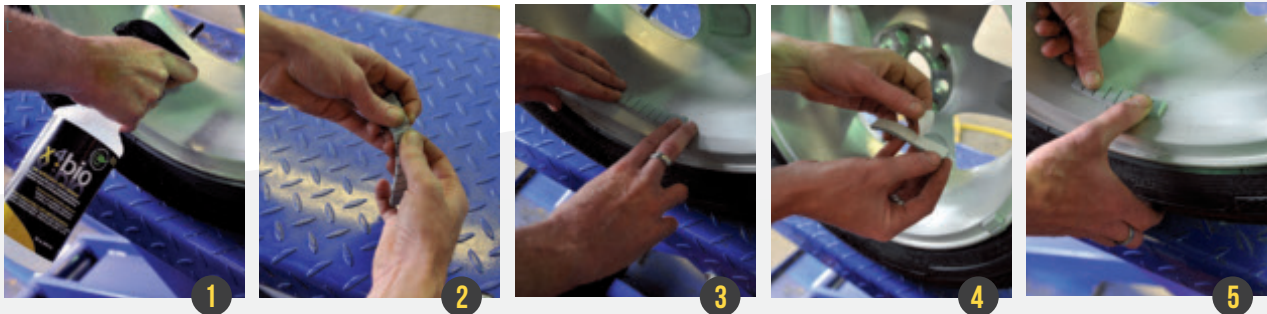

STEP 1 CLEANING

Clean the area where the wheel weight is to be applied using X4bio. To do so, spray the area thoroughly and then wipe with a clean soft cloth.

STEP 2 SELECT WEIGHT SIZE

Cut or break the adhesive weights apart depending on the size of weights needed.

STEP 3 CONTOURING

If the adhesive weight is not precontoured follow the instructions below, otherwise go directly to step 4. Before removing the liner, apply the weight against the wheel and using your fingers gently contour the shape to the radius of the wheel.

STEP 4 REMOVING LINER

Remove the liner and avoid touching the exposed adhesive.

STEP 5 APPLYING

Center the weight to the imbalance point. Using your fingers, apply a uniform pressure throughout the surface (do not use a hammer).

STEEL ADHESIVE WHEEL WEIGHTS

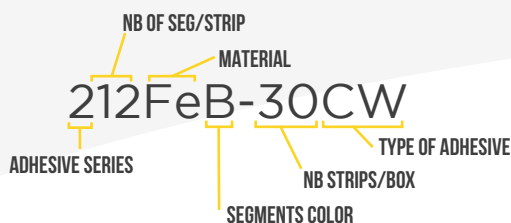

PLOMBCO'S NAMING SYSTEM ADHESIVE WHEEL WEIGHTS

200 SERIES - POLYESTER COATED

5 G SEGMENTS

PREMIUM LOW PROFILE FOR EASY CONTOURING | WIDTH 3/4 IN | LENGTH 5 1/4 IN

SILVER-GRAY



ADHESIVE	52-STRIPS/BOX 12 SEG/STRIP	30-STRIPS/BOX 12 SEG/STRIP	20 LB ROLL 1820 SEG
Standard	212FeS-52	212FeS-30	220FeS
CW	212FeS-52CW	212FeS-30CW	220FeS-CW

BLACK



ADHESIVE	30-STRIPS/BOX 12 SEG/STRIP
CW	212FeB-30CW

CHROMED



ADHESIVE	30-STRIPS/BOX 12 SEG/STRIP
CW	212FeC-30CW

300 SERIES

0.25 OZ SEGMENTS

LOW PROFILE FOR EVERYDAY APPLICATION | WIDTH 3/4 IN | LENGTH 7 1/4 IN



ADHESIVE	52-STRIPS/BOX 12 SEG/STRIP	30-STRIPS/BOX 12 SEG/STRIP	20 LB ROLL 1272 SEG
Standard	312Fe-52	312Fe-30	320Fe
CW	312Fe-52CW	312Fe-30CW	320Fe-CW

VALUE LINE SERIES

0.25 OZ SEGMENTS

COST-EFFICIENT LOW PROFILE FOR EVERYDAY APPLICATION | WIDTH 3/4 IN | LENGTH 7 5/8 IN



ADHESIVE	48-STRIPS/BOX 12 SEG/STRIP
Standard	VL312Fe-48

400 SERIES

0.5 OZ SEGMENTS

FOR EVERYDAY APPLICATION | WIDTH 3/4 IN | LENGTH 7 1/4 IN



ADHESIVE	48-STRIPS/BOX 8 SEG/STRIP	28-STRIPS/BOX 8 SEG/STRIP	20 LB ROLL 640 SEG	10 LB ROLL 320 SEG
Standard	408Fe-48	408Fe-28	420Fe	410Fe
CW	408Fe-48CW	408Fe-28CW	420Fe-CW	410Fe-CW
OE		408Fe-28OE	420Fe-OE	

500 SERIES

1 OZ SEGMENTS

FOR TRUCK APPLICATION | WIDTH 1 1/4 IN | LENGTH 6 3/4 IN



ADHESIVE	15-STRIPS/BOX 6 SEG/STRIP
Standard	506Fe-15
CW	506Fe-15CW

ADHESIVE WHEEL WEIGHTS RACKS

SINGLE HANGING RACK / H1



Part number: 50286

DOUBLE HANGING RACK / H2



Part number: 50288

TRIPLE FLOOR STAND RACK / FS3



Part number: 50287

LEAD ADHESIVE WHEEL WEIGHTS

COATED VS UNCOATED LOOK AT THE DIFFERENCE

All Plombco lead adhesive weights are coated. The coating colour matches most wheels which makes the product very aesthetic. The durable finish of the coating prevents also any colour degradation or change.

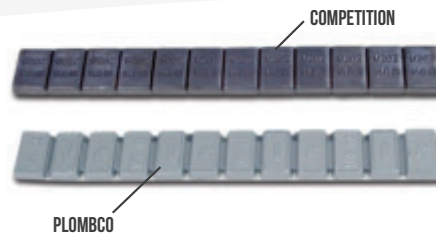

200 SERIES

5/10 G SEGMENTS

LOW PROFILE EUROPEAN STYLE | WIDTH 5/8 IN | LENGTH 4 IN



ADHESIVE

30-STRIPS/BOX
8 SEG/STRIP

Standard

214-30

300 SERIES

0.25 OZ SEGMENTS

312

LOW PROFILE FOR EVERYDAY APPLICATION | WIDTH 3/4 IN | LENGTH 6 IN

SILVER



ADHESIVE

52-STRIPS/BOX
12 SEG/STRIP

48-STRIPS/BOX
12 SEG/STRIP

30-STRIPS/BOX
12 SEG/STRIP

Standard

312-52

312-48

312-30

CW

312-52CW

312-30CW

BLACK BLACK MATTE FINISH



ADHESIVE

30-STRIPS/BOX
12 SEG/STRIP

CW

312B-30CW

314

NARROW FOR EVERYDAY APPLICATION | WIDTH 1/2 IN | LENGTH 6 IN



ADHESIVE

60-STRIPS/BOX
12 SEG/STRIP

30-STRIPS/BOX
12 SEG/STRIP

Standard

314-60

314-30

CW

314-60CW

314-30CW

400 SERIES

0.5 OZ SEGMENTS

FOR EVERYDAY APPLICATION | WIDTH 3/4 IN | LENGTH 6 IN



ADHESIVE	30-STRIPS/BOX 12 SEG/STRIP	15-STRIPS/BOX 12 SEG/STRIP
Standard	412-30	412-15
CW	412-30CW	412-15CW

500 SERIES

1 OZ SEGMENTS

FOR TRUCK APPLICATION | WIDTH 3/4 IN | LENGTH 6 IN



ADHESIVE	15-STRIPS/BOX 6 SEG/STRIP
Standard	512-15
CW	512-15CW

600 SERIES

2 OZ SEGMENTS

FOR TRUCK APPLICATION | WIDTH 1 1/4 IN | LENGTH 6 IN



ADHESIVE	15-STRIPS/BOX 6 SEG/STRIP	8-STRIPS/BOX 6 SEG/STRIP
Standard	612-15	612-8
CW	612-15CW	612-8CW



ZINC ADHESIVE WHEEL WEIGHTS

CZAS SERIES

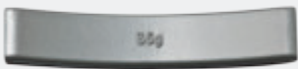

ADHESIVE	25-PIECES/BOX
OE	CZAS-OE

*Available from 5 g to 35 g
*Width approx. 20 mm (3/4 inches)
Low profile style individually sized adhesive wheel weights pre-contoured to match the radius of the wheel.

CCZAS SERIES



ADHESIVE	25-PIECES/BOX
CW	CCZAS-CW

*Available from 5 g to 60 g
*Width approx. 20 mm (3/4 inches)
Individual adhesive wheel weights pre-contoured.

PCZAS SERIES



ADHESIVE	25-PIECES/BOX
OE	PCZAS-OE
CW	PCZAS-CW

*Available from 5 g to 60 g
*65 to 80 g in lead version (PCAS)
*Width approx. 20 mm (3/4 inches)
European style individually sized adhesive wheel weights pre-contoured to match the radius of the wheel.

The image shows a collection of small, rectangular bins in yellow, blue, and orange, arranged in a grid. Each bin is filled with small, green, cylindrical pellets. The bins are labeled with their weight in ounces and grams, and some are labeled with 'MC' or 'IAW'. A large, bold, yellow and white text overlay is centered in the image.

MANAGEMENT SYSTEMS

1.25 OZ
MC

1.25 OZ
IAW 35 g

1.50 OZ
MC

1.50 OZ
IAW 45 g

1.75 OZ
MC

1.75 OZ
IAW 50 g

MANAGEMENT SYSTEMS

KIT 2000 Available in **PLASTEEL®**, **ZINC**, **STEEL** & **LEAD**

THE ULTIMATE KIT FOR THE TIRE PROFESSIONAL COVER OVER 95% OF TODAY'S BALANCING NEEDS.



Part number: Plasteel® 52033
Zinc 52031
Steel 52028
Lead 52027

Dimension: 48"W x 25"D x 75"H

Includes

1 Metal floor stand
1 Header
74 Pre-labeled plastic bins
2100 Wheel Weights

for Plasteel®, zinc and steel kits

25 of each size for every passenger series
(For a complete assortment,
Plasteel® kit includes PFe and LHFe)

for lead kit

50 of each size for REG series
25 of each size for every other passenger series
1 Box of adhesive weights (312Fe-52)
1 Tool WR 305-25 PC
1 Application chart
1 Rim gauge
1 Catalog

Also available:

Kit 6500

(same stand & accessories as Kit 2000)

Includes:

6500 wheel weights
50 of each size for LH & EN series
100 of each size for PFe, MC, IAW, FN,
T & AW series

Plasteel® - **Part number:** 52032

Steel - **Part number:** 52030

Kit 80

Empty metal floor rack, without wheel weights and tool

Part number: 52029

Replacement parts:

Metal frame - **Part number:** 50283

Back panel Top - **Part number:** 50281

Bottom - **Part number:** 50280

Header - **Part number:** 45001

Bins (assorted colors available)

Labels - **Part number:** 45014

KIT 1000 Available in **PLASTEEL®**, **ZINC**, **STEEL** & **LEAD**

THE BASIC KIT FOR THE TIRE PROFESSIONAL



Part number: Plasteel® 52023
Zinc 52024
Steel 52026
Lead 52025

Dimension: 48"W x 28"D x 42 1/2 "H

Includes

1 Metal floor stand
1 Header
40 Pre-labeled plastic bins
1100 Wheel Weights
In various sizes and quantities
to reflect the everyday usage needs
1 Box of adhesive weights (312Fe-30)
1 Tool WR 305-25 PC
1 Application chart
1 Rim gauge
1 Catalog

Also available:

Kit 40

Empty metal floor rack, without wheel weights and tool

Part number: 52002

Replacement parts:

Metal frame - **Part number:** 50284

Back panel - **Part number:** 50281

Header - **Part number:** 45001

Bins (assorted colors available)

Labels - **Part number:** 45014

KIT 420 Available in **ZINC** & **LEAD**

THE ULTIMATE TRUCK ASSORTMENT



Part number: Zinc 52421
Lead 52420

Dimension: 48"W x 28"D x 42 1/2 "H

Includes

1 Metal floor stand
1 Header
24 Pre-labeled plastic bins
420 Wheel Weights
25 of each size for LT1 & LT2 series
10 of each size for CT, I7 & TALS series
1 Tool PT7-UB
*substitute LT2 for RC in Kit 420 zinc
1 Catalog

Also available:

Kit 24

Empty metal floor rack, without wheel weights and tool

Part number: 52424

Replacement parts:

Metal frame - **Part number:** 50284

Back panel - **Part number:** 50281

Header - **Part number:** 45003

Bins (assorted colors available)

Labels

TOOLS & ACCESSORIES

CATALOG

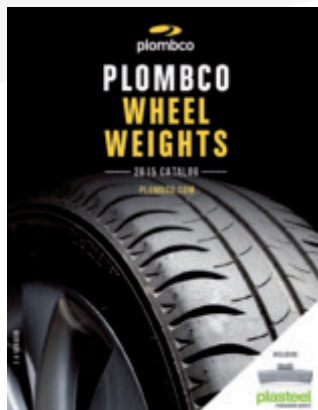

Part number: 45011

APPLICATION BOOKLET



Passenger cars and light trucks
Part number: 44998

APPLICATION WALL CHART



Passenger cars and light trucks
Dimension: 36" x 21"
Part number: 45012

RIM GAUGE



Part number: 45010

PLASTEEL® SAMPLE KIT



Includes: - Assortment of Plasteel® premium wheel weights
- 4 page handout
- Promotional material
Part number: 51150

TOOLS & ACCESSORIES

PA6 - ADHESIVE SCRAPER



Adhesive wheel weight removal
Part number: 43009

PT7-UB



Superior quality and extra strong tool for fitting weights on heavy trucks
Part number: 42007

WR105



Used for BMW & Mercedes two-piece weights. This tool allows the clip to be pulled open to insert the weight.
Part number: 43005

WR305-25 PC



Used for fitting polyester-coated weights
Part number: 42015
Replacement part available : Head **Part number** 42011

WR305-25K



Basic wheel weight installation and removal tool
Part number: 42001

WR305-50



Wheel weight installation and removal tool
Part number: 42006

WR305-100



Professional wheel weight installation and removal tool
Part number: 42008
Replacement part available : Head **Part number** 42010

WR1000



Rugged truck hammer for installation and removal
Part number: 43010
Replacement parts available : Hook **Part number** 42013
Head **Part number** 42014

SPECIALTY **WHEEL** **WEIGHTS**



SPECIALTY WHEEL WEIGHTS

82
Pb
207.20

MOTOCYCLE WHEEL WEIGHTS

B42

10 g to 30 g



Used for alloy rim, lip less than 10 mm.

B44

10 g to 30 g



Used for alloy rim, lip more than 10 mm

B61

10 g to 30 g

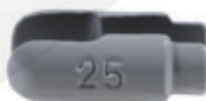

Used for universal spoke rim

30
Zn
65.38

2 PIECES OE STYLE WHEEL WEIGHTS

BMNZS BMW

5 g to 60 g



Two-piece weight for BMW designed for scratchless installation. Use tool WR 105 to open the clip. May also be used for other European vehicles when ENS series is specified.

MBNZS MERCEDES

5 g to 60 g



Two-piece weight for Mercedes designed for scratchless installation. Use tool WR 105 to open the clip. May also be used for other European vehicles when ENS series is specified.

30
Zn
65.38

ZINC ADHESIVE WHEEL WEIGHTS

CZAS SERIES

ADHESIVE	25-PIECES/BOX
OE	CZAS-OE

*Available from 5 g to 35 g
*Width approx. 20 mm (3/4 inches)

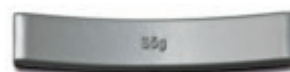

Low profile style individually sized adhesive wheel weights pre-contoured to match the radius of the wheel.

CCZAS SERIES

ADHESIVE	25-PIECES/BOX
CW	CCZAS-CW

*Available from 5 g to 60 g
*Width approx. 20 mm (3/4 inches)



Individual adhesive wheel weights pre-contoured.

PCZAS SERIES

ADHESIVE	25-PIECES/BOX
OE	PCZAS-OE
CW	PCZAS-CW

*Available from 5 g to 60 g
*65 to 80 g in lead version (PCAS)
*Width approx. 20 mm (3/4 inches)



European style individually sized adhesive wheel weights pre-contoured to match the radius of the wheel.



PLOMBCO.COM

1 800 611-7074
450 371-8800
FAX 450 371-0812

66, EDMOND STREET, VALLEYFIELD, QUÉBEC, CANADA J6S 3E8